

Type CG Crossgard Clutch

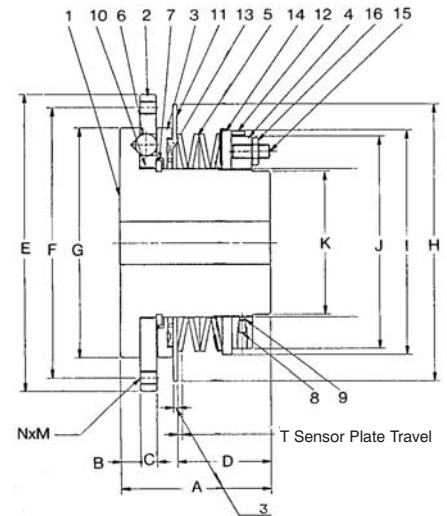

Provides low cost overload protection with simple setting and operation, whilst maintaining synchronisation of driving elements

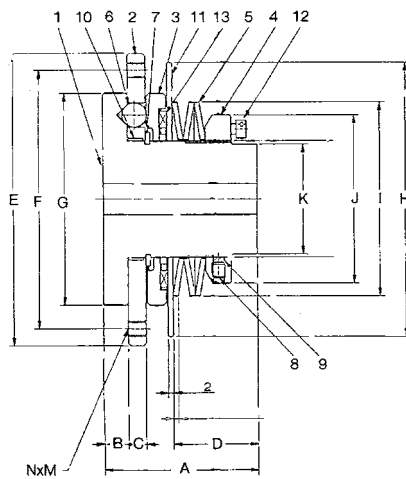

- 1 Hub
- 2 Centre Flange
- 3 Plate
- 4 Adjusting Nut
- 5 Disc Spring
- 6 Steel Ball
- 7 Snap Ring
- 8 Set Screw
- 9 Lock Plug
- 10 Skid Bearing
- 11 Sensor Plate
- 12 Indicator
- 13 Bearing
- 14 Pressure Plate
- 15 Adjusting Bolt
- 16 Adjusting Nut

Model	Torque Nm		Max. Speed RPM	Disc Spring Colour	Bore Size		Weight kg.	Inertia kgfm ² x 10 ⁻²
	Min	Max			Min	Max		
CG20	10	44	700	Orange	8	20	0.9	0.23
CG30L CG30H	20 54	54 167	500	Yellow Orange	12	30	2.0	0.79
CG50L CG50M CG50H	69 137 196	147 412 539	300	Yellow Blue Orange	22	50	5.9	4.84
CG70	294	1080	160	Orange	32	70	17.0	25.2
CG90L CG90H	441 931	1323 3136	120	Yellow Orange	42	90	37.5	135
CG110L CG110H	686 1568	1960 5096	100	Yellow Orange	52	110	69.6	364
CG130L CG130H	1176 2646	3038 7154	80	Yellow Orange	60	130	102.0	688

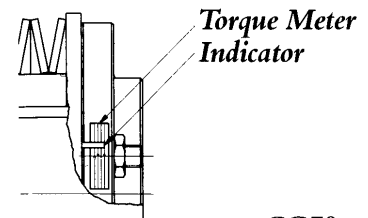
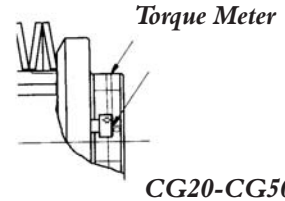

Dimensions in mm

Model	A	B	C	D	Eh ²	F	G	H	I	J	K	M	N (No.)	R	S	T
CG20	47	7.5	5.7	25	90	78	62	82	54	48	30	M5	4	5.5	65	1.8
CG30	60	9.5	7	33	113	100	82	106	75	65	42.5	M6	6	6.5	85	2.0
CG50	81	14.5	8.5	44.8	160	142	122	150	117	98	70	M8	6	9.0	125	2.7
CG70	110	14.5	12	68.5	220	200	170	205	166	157	106	M10	6	11.0	175	3.3
CG90	157	25.0	22	88.6	295	265	236	290	213	203	124	M12	8	13.0	242	5.4
CG110	195	30.0	25	105	355	325	287	345	278	266	155	M16	6	17.0	295	6.0
CG130	230	35.0	27	130	400	360	319	390	316	304	184	M16	8	17.0	330	6.6

Dimensions for Mounting Drive Sprockets

Model	A mm	B mm	C mm	D mm	N
CG20	65	78	90.06/ 90.02	5.5	4
CG30	85	100	113.08/113.02	6.5	6
CG50	125	142	160.10/160.02	9.0	6
CG70	175	200	220.10/220.02	11.0	6
CG90	241	265	295.10/295.02	13.0	8
CG110	292	325	355.12/355.02	17.0	6
CG130	324	360	400.12/400.02	17.0	8

Driving members can be Timing Belt Pulleys, Vee-Belt Pulleys, Spur Gears or most common, Roller Chain Sprockets. For roller chain the minimum number of teeth sprocket which can be used is shown in the table below:

Model	CHAIN PITCH (INCHES)								
	¼	8mm	¾	½	¾	1	1½	2	
CG20	48	40	34	26	22				
CG30	60	48	41	32	26	22			
CG50			57	43	35	30	24		
CG70				58	47	40	31		
CG90						47	36	25	
CG110							44	30	26
CG130								33	29

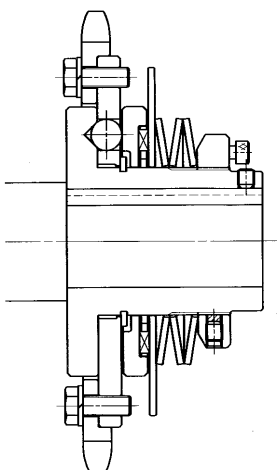

Typical Sprocket Assembly

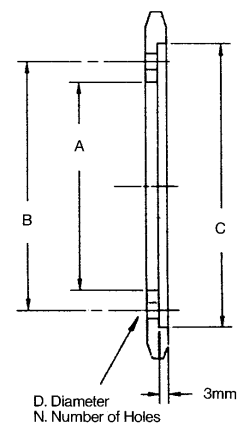

Tel: +44 121 360 0155

Fax: +44 121 325 1079

Email: sales@crossmorse.com